



www.devatec.com

ElectroVap MC2

What will make you prefer the ElectroVap MC2 ? :

- ◆ Easy installation & operation
- ◆ Low maintenance cost
- ◆ Efficiency & durability
- ◆ Wide range of steam capacities & voltages
- ◆ Optimized water consumption
- ◆ Environmentally friendly plastic cylinder.

The ElectroVap MC2 gives you all that you could expect from a modern humidifier !



The ElectroVap MC humidifier produces a sterile and mineral free steam. It gives an accurate and reliable control over humidity by accepting 0-10 V, 0-20 V, 4-20 mA, integral or on/off controls.



Easy installation and maintenance at moderate cost. The steam cylinders have to be cleaned or changed regularly depending on the water quality and the steam demand.



A backlit LCD display provides real-time information on what is going on. Pressing the buttons will enable you to navigate easily among the three menus (humidifier configuration, changing unit configuration and humidifier status).



ExpressPack™: this is a multi-tube steam dispersion panel that accepts atmospheric source steam and discharges it into a duct or air handling unit. It allows to shorten the humidification distance in restricted ventilation ducts and AHUs to about 600 mm (24").

Technical features

Supply (V)	220V - 1 ph				230 V - 1 ph				208V - 3 ph				220V - 3 ph				230V - 3 ph				Nb CYL
	ELMC	Kg/h	Lbs/h	A Kw (np)	Kg/h	Lbs/h	A Kw (np)	Kg/h	Lbs/h	A Kw (np)	Kg/h	Lbs/h	A Kw (np)	Kg/h	Lbs/h	A Kw (np)	Kg/h	Lbs/h	A Kw (np)		
5	5	11	17.1	3.8	5	11	16.3	3.75	5	11	9.6	3.78	5	11	9.9	3.8	5	11	9.6	3.78	1
8	-	-	-	-	-	-	-	-	8	18	15.3	6.02	8	18	15.8	6	8	18	15.3	6.02	1
10	10	22	34.2	7.5	10	22	32.7	7.52	10	22	19.1	7.51	10	22	19.7	7.5	10	22	19.1	7.51	1
15-2	-	-	-	-	-	-	-	-	15	33	28.7	11.29	15	33	29.6	11.3	15	33	28.7	11.29	1
20	-	-	-	-	-	-	-	-	20	44	38.2	15.02	20	44	39.5	15	20	44	38.2	15.02	1
25	-	-	-	-	-	-	-	-	25	55	47.8	18.80	25	55	49.3	18.8	25	55	47.8	18.80	1
30	-	-	-	-	-	-	-	-	32	70	62.9	24.74	32	70	63.1	24.1	32	70	62.9	24.74	2
40	-	-	-	-	-	-	-	-	40	88	76.5	30.09	40	88	78.9	30.1	40	88	76.5	30.09	2
50	-	-	-	-	-	-	-	-	50	110	86	33.82	50	110	98.7	37.6	50	110	86	33.82	3
60	-	-	-	-	-	-	-	-	60	132	95.6	37.60	60	132	118.4	45.1	60	132	95.6	37.60	3
70	-	-	-	-	-	-	-	-	70	154	114.7	45.11	70	154	138.1	52.6	70	154	114.7	45.11	3

Nb CYL : Number of cylinders - np = nominal power

Supply (V)	380V - 3 ph				400V - 3 ph				Nb CYL
	ELMC	Kg/h	Lbs/h	A Kw (np)	Kg/h	Lbs/h	A Kw (np)	Kg/h	
5	5	11	5.7	3.8	5	11	5.5	3.76	1
8	8	18	9.1	6	8	18	8.8	6.02	1
10	10	22	11.4	7.5	10	22	11	7.52	1
15-2	15	33	17.1	11.3	15	33	16.5	11.29	1
20	20	44	22.8	15	20	44	22	15.05	1
30	30	66	34.3	22.6	30	66	33	22.57	1
30 HC	33	72	38	24.69	33	73	36.3	24.83	1
40	40	88	45.7	30.1	40	88	44	30.1	2
50	50	110	57.1	37.6	50	110	55	37.62	2
60	60	132	68.5	45.1	60	132	66	45.14	2
60 HC	66	145	76	49.38	66	145	72.6	49.66	2
90	90	198	102.8	67.5	90	198	89.9	67.65	3
90 HC	99	218	114	74.08	99	218	9	74.49	3

Supply (V)	415V - 3 ph				440V - 3 ph				460V - 3 ph				480V - 3 ph				575V - 3 ph				600V - 3 ph				690V - 3 ph				Nb of cylinders
	ELMC	Kg/h	Lbs/h	A Kw (np)	Kg/h	Lbs/h	A Kw (np)	Kg/h	Lbs/h	A Kw (np)	Kg/h	Lbs/h	A Kw (np)	Kg/h	Lbs/h	A Kw (np)	Kg/h	Lbs/h	A Kw (np)	Kg/h	Lbs/h	A Kw (np)	Kg/h	Lbs/h	A Kw (np)	Kg/h	Lbs/h	A Kw (np)	
5	5	11	5.3	3.76	5	11	5	3.76	5	11	4.8	3.78	5	11	4.6	3.76	5	11	3.8	3.74	5	11	3.7	3.76	5	11	3.2	3.78	1
8	8	18	8.5	6.03	8	18	8	6.02	8	18	7.6	5.98	8	18	7.3	6.02	8	18	6.1	6	8	18	5.9	6.02	8	18	5.1	6.02	1
10	10	22	10.6	7.52	10	22	10	7.52	10	22	9.6	7.55	10	22	9.2	7.52	10	22	7.6	7.47	10	22	7.3	7.52	10	22	6.4	7.55	1
15-2	15	33	15.9	11.28	15	33	15	11.29	15	33	14.3	11.25	15	33	13.7	11.28	15	33	11.5	11.31	15	33	11	11.28	15	33	9.6	11.33	1
20	20	44	21.2	15.04	20	44	20	15.05	20	44	19.1	15.02	20	44	18.3	15.04	20	44	15.3	15.04	20	44	14.7	15.04	20	44	12.7	14.98	1
30	30	66	31.8	22.57	30	66	30	22.57	30	66	28.7	22.58	30	66	27.5	22.56	30	66	22.9	22.52	30	66	22	22.56	30	66	19.1	22.54	1
30 HC	33	72	35	24.84	-	-	-	33	72	32	25.17	33	72	30	24.62	33	72	25	24.58	33	72	24	24.62	33	72	21	24.78	1	
40	40	88	42.4	30.09	40	88	40	30.10	40	88	38.2	30.05	40	88	36.6	30.08	40	88	30.6	30.09	40	88	29.3	30.08	40	88	25.5	30.09	2
50	50	110	53.04	37.61	50	110	50	37.62	50	110	47.8	37.6	50	110	45.8	37.59	50	110	38.2	37.56	50	110	36.6	37.59	50	110	31.9	37.64	2
60	60	132	63.6	45.13	60	132	60	45.14	60	132	57.4	45.15	60	132	55	45.11	60	132	45.9	45.13	60	132	44	45.11	60	132	38.2	45.07	2
60 HC	66	145	70	49.68	-	-	-	66	145	63	49.56	65	143	60	49.25	65	143	50	49.19	65	143	48	49.25	66	145	42	49.56	2	
90	90	198	95.4	67.7	90	198	90	67.72	90	198	86	67.65	90	198	82.4	67.67	90	198	68.8	67.65	90	198	66	67.67	90	198	57.4	67.73	3
90 HC	99	218	105	74.51	-	-	-	99	218	95	74.73	99	218	91	74.69	99	218	76	74.73	98	216	72	73.87	99	218	63	74.33	3	

ELMC in 400/3/50-60	Dimensions in mm / in. (L x H x D)	Steam output mm / in.	Net weight kg / lbs	Weight in operation kg / lbs
ELMC 5 to 15-2	475 x 540 x 217 / 18.70 x 21.26 x 8.54	1 x Ø 25 - 1"	15 / 33	23 / 51
ELMC 20 & 30	550 x 680 x 272 / 21.65 x 26.77 x 10.71	1 x Ø 40 - 1.57"	22 / 49	37 / 82
ELMC 40 to 60	845 x 680 x 272 / 33.27 x 26.77 x 10.71	2 x Ø 40 - 1.57"	30 / 66	60 / 132
ELMC 90	1075 x 680 x 272 / 42.32 x 26.77 x 10.71	3 x Ø 40 - 1.57"	45 / 99	90 / 198

Operating range :

- ♦ Water conductivity between 30 and 1000 $\mu\text{S}/\text{cm}$.
- ♦ Room temperature between 5°C and 40°C (41-104°F) max , and 80% RH maximum.
- ♦ Water pressure between 1 & 6 bar (15 to 90 psi) at 40°C (104°F) maximum.
- ♦ For duct applications up to 150mm (5.9 ") WC.
- ♦ 50 or 60 Hz operating mode.
- ♦ RS485 interface board (JBUS or MODBUS protocol) ensuring BMS communication with the humidifier.

New cylinder using sustainable materials :

- ♦ Reinforced polypropylen material for **better resistance to shock**.
- ♦ Fitted with plain stainless steel electrode plates easily cleanable
- ♦ Disposable or cleanable cylinder for hard waters - special models for softened waters (TH 0° to 2°) or DI waters (30 $\mu\text{S}/\text{cm}$ mini).

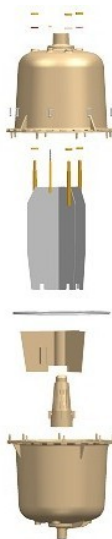

Accessories :

Stainless steel steam distribution pipes, room blower packs, steam and condensate hoses, humidity sensors and humidistats...

Optional features :

- ♦ Remote information board providing feedback on maintenance, general failure and steam production.
- ♦ Filling cup platform for duct pressures between 150 & 300 mm (5.9 " - 11.8 ") of water column.
- ♦ Anti-freeze device where the water is kept at 65°C (149°F)
- ♦ Protective enclosures for external installation.
- ♦ Support legs also available for ground installation
- ♦ Waste water tank to make humidifier draining easier.

Other voltages on request



Protective enclosures



Support legs



Waste water tank



Blower packs

devatec 87 rue Feu St Eloi
76550 Ambrumesnil - France

Export division: tel. +33 (0)2 35 83 06 44 or +33 (0)2 35 83 03 86
fax. +33 (0)2 35 85 36 72
Email: export@devatec.com - www.devatec.com



Agreements :



LR 94104-2

POCC FR.AB28.B03172

devatec reserves the right to change specifications or design of the equipment described herein without prior notice.